

A1cNow Quick Start Guide

This will get you testing in a few easy steps!

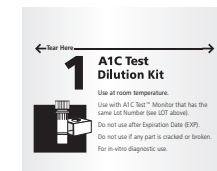

Sample Dilution Kit

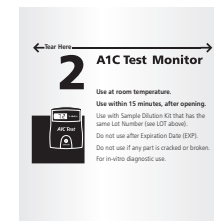

Monitor Pouch

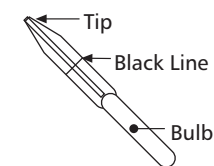

Blood Collector

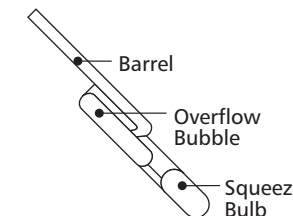

Sample Dropper



Tube



Tube Holder

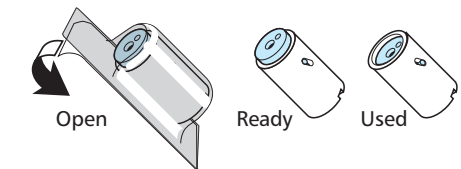

Single-use Lancet

Do not open the pouches until ready to use. If refrigerated, allow all parts of the test kit to come to room temperature (64-82°F or 18-28°C) for at least one hour before using. Do not apply blood directly to Monitor, dilute first.

See back of Sample Dilution Kit for the Blood Collector and the Sample Dropper. Read detailed information in Overview and Helpful Hints before doing a test.

1 Create Your Sample

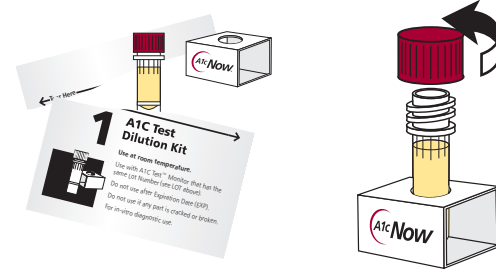

To start, tear open the Sample Dilution Kit. Place the Tube in the Tube Holder and remove the Red Cap from the Tube.

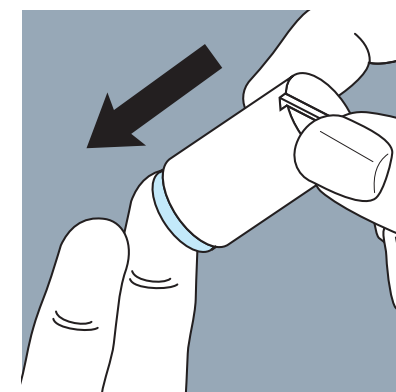

Place the blue end of Lancet firmly against your finger and push down until it clicks.

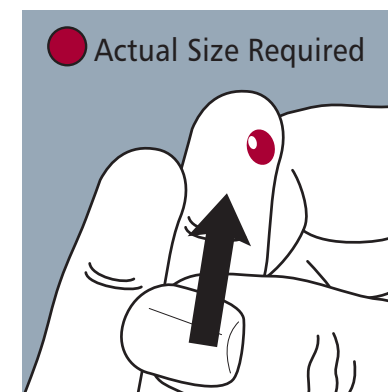

Gently massage your finger until you see a large drop of blood.

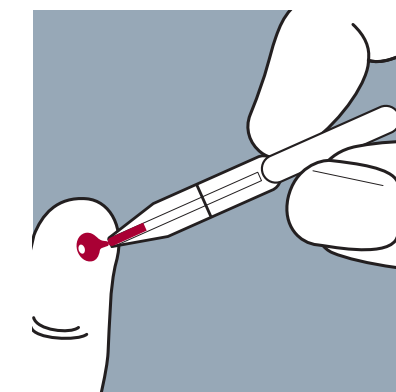

Hold the Blood Collector horizontally and gently touch the Tip of the Blood Collector to the drop of blood.

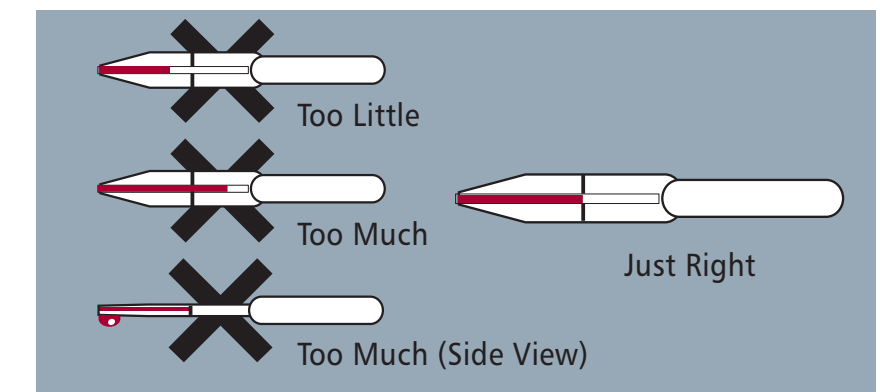

Do not squeeze the bulb. Fill to the Black Line and stop. If slightly overfilled, touch Tip with tissue to remove excess.

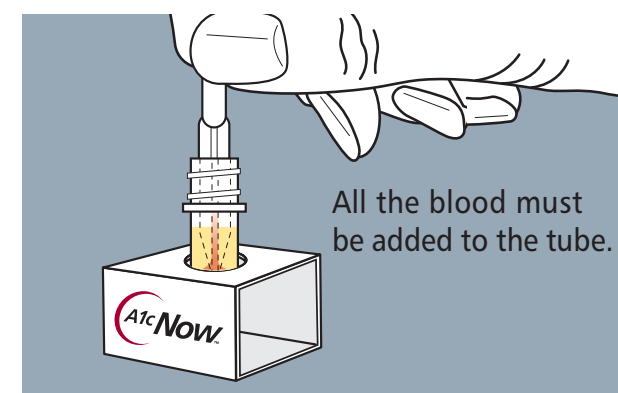

Drop the Blood Collector Tip first into the Tube. Add your blood by squeezing the Bulb. Squeeze the Bulb two or three times to rinse out the blood.

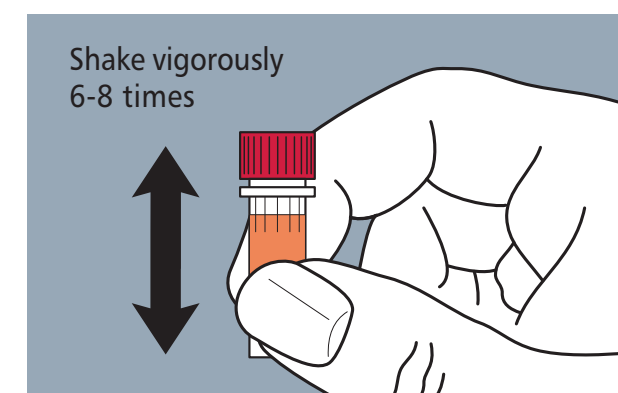

Recap the Tube tightly and shake the Tube to completely mix the blood and liquid. It is OK to have bubbles. The diluted sample will be red-orange in color.

Continue →

See Other Side to Start



2

Apply Your Sample

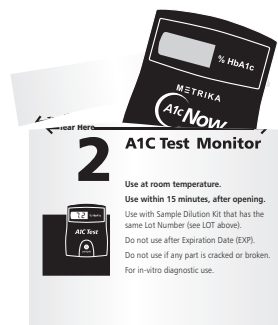

Use within 15 minutes.

Tear open the Monitor Pouch. Place the Monitor on a flat surface away from direct sunlight and hot or cold surfaces.

Once the pouch is open, use the Monitor in 15 minutes. Monitor will turn on when sample is applied.

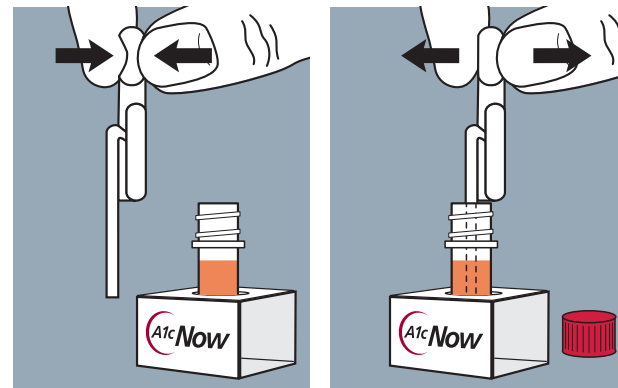

Remove the Red Cap from the Tube.

Squeeze the Bulb on the Sample Dropper. Put the open end into the liquid. Release the Bulb to fill the Barrel of the Sample Dropper.

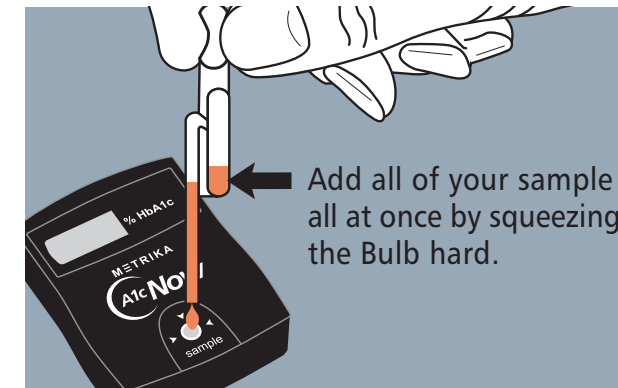
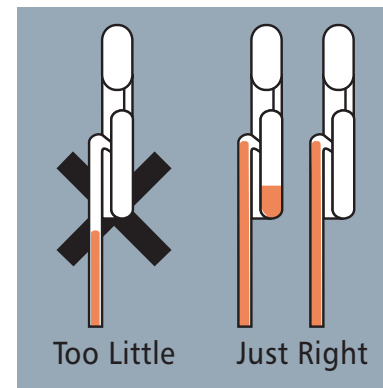

Hold the Sample Dropper slightly above the sample opening of the Monitor.

Do not handle the Monitor after adding the sample.

3

Read and Record Your Result

First, you will see "----" on the display of the Monitor. Then the Monitor will countdown from eight minutes and display the result.

Your result will be shown alternating with "QCOK" in the display. This means all of the internal QC (Quality Control) checks have passed.

If your test result is not a number, for example "OR2" or "QC60," refer to Overview and Helpful Hints.

Inform your health care professional of your result using the enclosed card, or follow your doctor's instructions.

Need help?
Call Metrika toll free
at 877-212-4968.
We are open weekdays
6AM to 5PM Pacific Standard Time.

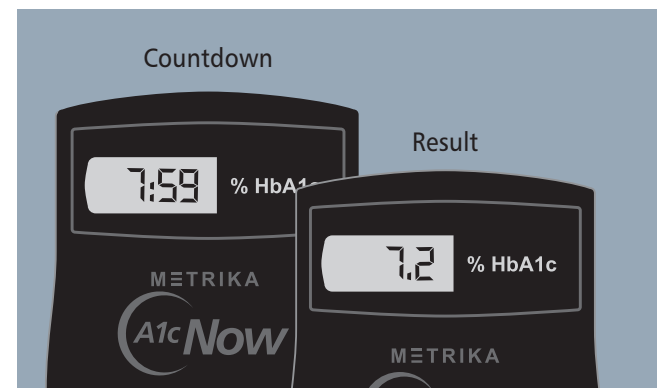

Result Log

Result
Date
Lot Number (on box)

ADA recommends testing at least 2 times per year or more often if your blood sugar is high or if your treatment plan changes.

